

[Skip to content](#)

## Manuals+

User Manuals Simplified.



# CREALITY CR-100 3D Printer User Guide

Home » [Creality](#) » CREALITY CR-100 3D Printer User Guide 

# CREALITY

CR-100 Guide Book



<http://qr16.cn/BsinVW>

This guidebook is for standard CR-100.  
Detailed instructions for users are available on the TF card.

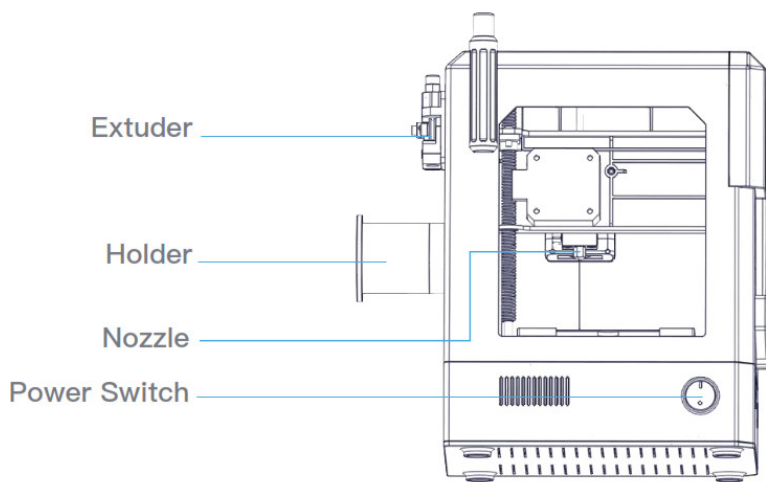
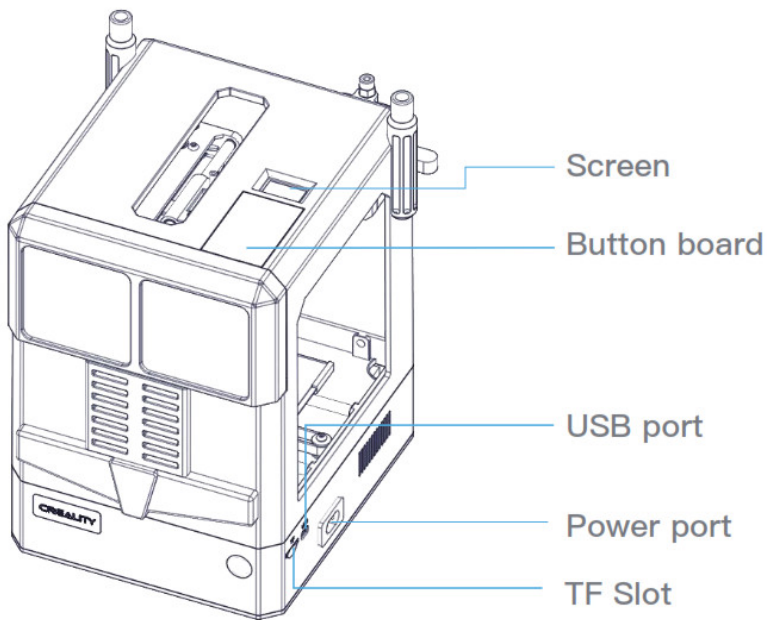

### Parameter

Model	CR-100
Molding Tech.	FDM
Printing Size	100*100*80mm
Printing Speed	c.180mm/s, Normal 30-60MM/S
Precision	±0.1 mm
Layer Thickness	0.1-0.4mm
Nozzle Diameter	0.4mm
Nozzle Temp.	2000
Printing Mode	TF card One-button Print, offline printing, Remote printing
File Format	stl, obj, amf
Slice Software	Crealty Slicer/Cura/Simplify3D
Power Supply	Input:100-240V AC 1.2A 50/60Hz Output:DC 12V 5.0A
Total Power	60W
Filament	(1)1.75mm PLA

Contents [ [hide](#) ]

- [1 Function Description](#)
- [2 Load Filament](#)
- [3 Installation Holder](#)
- [4 Install Platform](#)
- [5 One-button Print](#)
- [6 File Downloads](#)
- [7 Related Manuals](#)

## Function Description



### Remote Control

#### Start/Pause:

First Click : Start to Printing after heating to 200°C

Second Click: Stop printing

Third Click: Continue Printing



### Button Panel

**Home:** Return to origin

First Click: Heating to 200°C

Second Click: Stop to heat, Cooling to room temperature

**Heat/Cool:**

### Load Filament

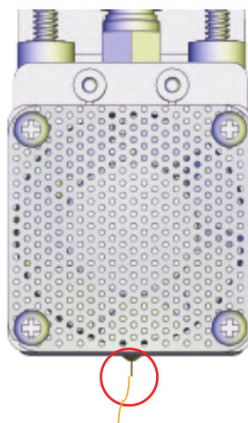

1. Pressing  to heat waiting the temperature of

nozzle to arrive 200°C.

2. Pressing the extrusion clamp, pass the filament through the extruder and PTFE tube into the nozzle, until the filament overflow

\*After heating, Press the extrusion clamp, pull out the filament to remove.

### Installation Holder

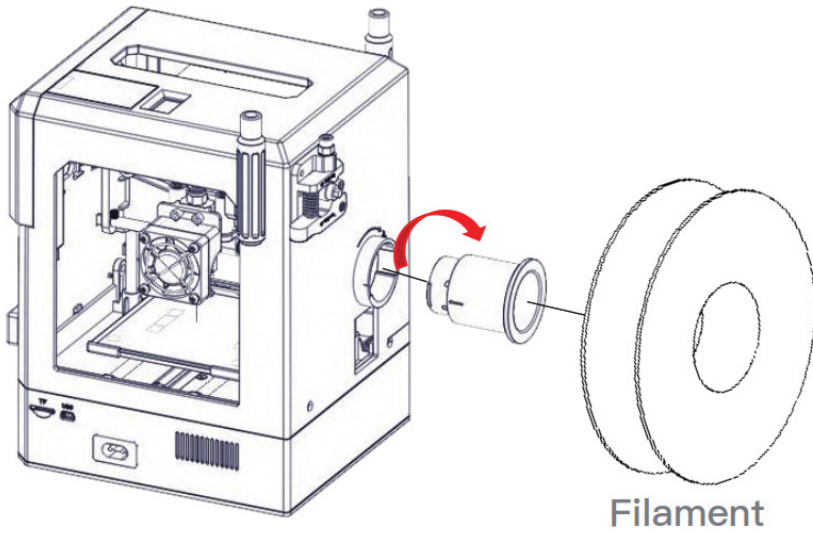

1. Insert the holder into the mounting hole then turn it to the right to lock it.
2. Put the filament on the holder.

### Install Platform

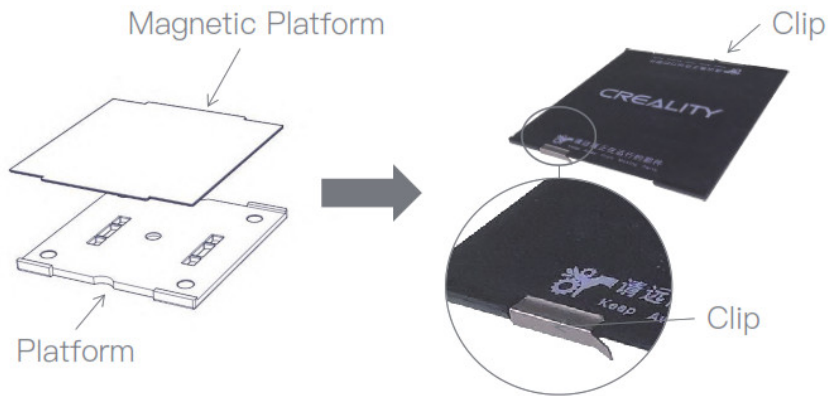

fix it by clips.

Place the magnetic platform on the printing platform, and

### One-button Print

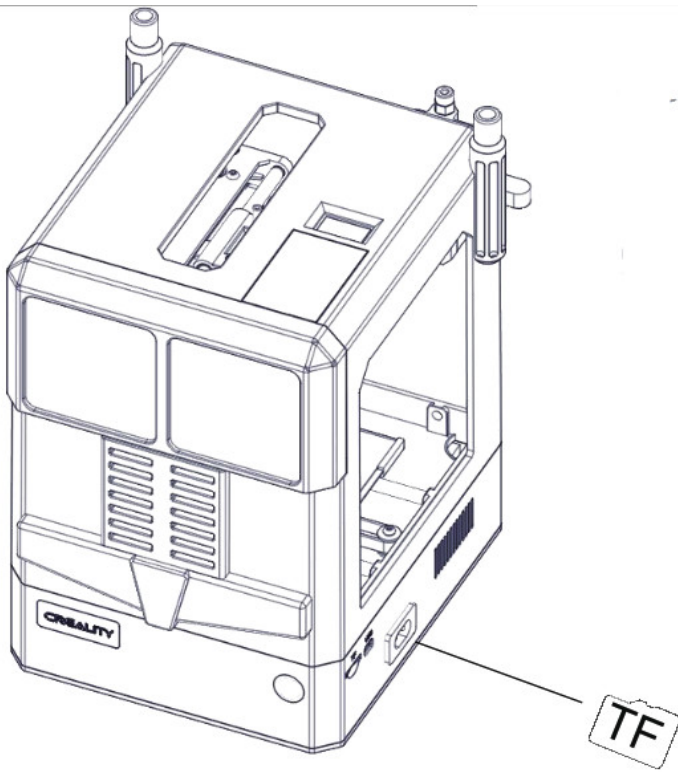

1. Insert the TF card into the TF slot of the printer
2. Click to wait for the nozzle to heat up to 200 ° C
3. Model will be printed after 2 minutes  
\* It only will print the first model in the TF card

#### Note



In case of emergency, please turn off the power of the 3D printer directly.



Please use a 3D printer in a spacious, level, and well ventilated environment.



It is recommended that using printer in the temperature of 8°C-40°C and a humidity of 20% – 50%. outside this range may result in poor printing results.



Do not disassemble the 3D printer without permission.

If you have any problems, please contact: [cs@creality3d.cn](mailto:cs@creality3d.cn)



Run "User Guide" in the TF card for more usage information.

#### File Downloads



CREALITY User Guide [Download](#) [optimized]

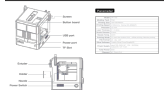

CR-100 3D Printer [Download](#)

#### Related Manuals

1. [Creality CR-10S Pro V2 3D Printer User Manual](#) CR-10S Pro V2 3D Printer Notes Do not use the...
2. [Creality Ender-3 3D Printer User Manual](#) CREALIY 3D Printer User Manual Ender-3 V2 Content Dear Consumers,...
3. [Creality 3D Ender 3D Printer Instruction Manual](#) Ender-3 3D Printer Instructions for assembly This guide is for...
4. [sainSMART Creality Ender-3 V2 3D Printer User Manual](#) sainSMART Creality Ender-3 V2 3D Printer User Manual – Optimized...
5. [MONOPRICE 3D Printer User Guide](#) MONOPRICE 3D Printer User Guide Remove the Printer and Accessory...
6. [FLASHFORGE Inventor 3D Printer User Guide](#) FLASHFORGE Inventor 3D Printer User Guide Caution Do not peel...